

# Eastern Metal Supply

## EMS-1000 ACM RAINSCREEN PANEL ATTACHMENT SYSTEM



### EMS PARTNERS WITH 3AC TO SUPPLY AN APPROVED EXTRUDED ALUMINUM ATTACHMENT SYSTEM

EASTERN METAL SUPPLY (EMS) now offers an approved extruded aluminum ACM attachment system in conjunction with testing successfully completed while partnering with 3A Composites for their ALUCOBOND® PLUS panels. The EMS extruded attachments are an easy to install Drained and Back Ventilated system (DBV). Our pre-engineered system is efficient and cost effective.

**It provides the ability to adhere to AAMA 509-09 DBV rainscreen, NFPA 285 flame spread, ASTM E330 deflection and ASTM E72 serviceability testing.**



Eastern Metal Supply

ALUCOBOND® PLUS

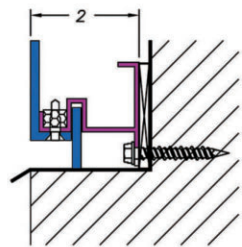
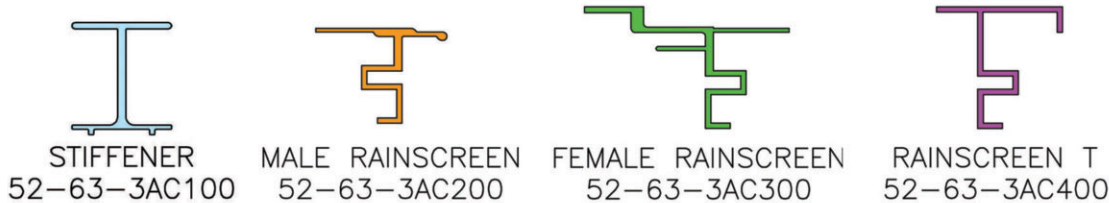

SILL DETAIL

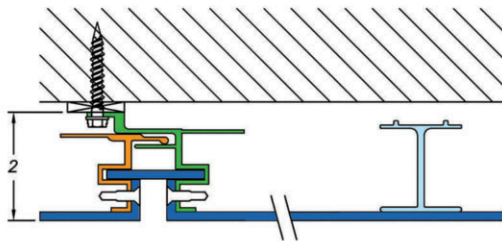

VERTICAL JOINT SHOWING STIFFENER

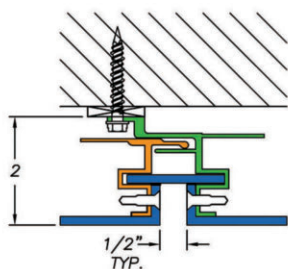

VERTICAL JOINT DETAIL

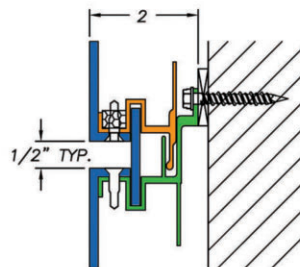

HORIZONTAL JOINT DETAIL

ALUCOBOND® PLUS

Detail views are shown  
as Dry Seal with no  
continuous insulation

#### CODE APPROVALS

- AAMA 509-09 DBV rainscreen
- NFPA 285 flame spread
- ASTM E330 deflection
- ASTM E72 serviceability testing.

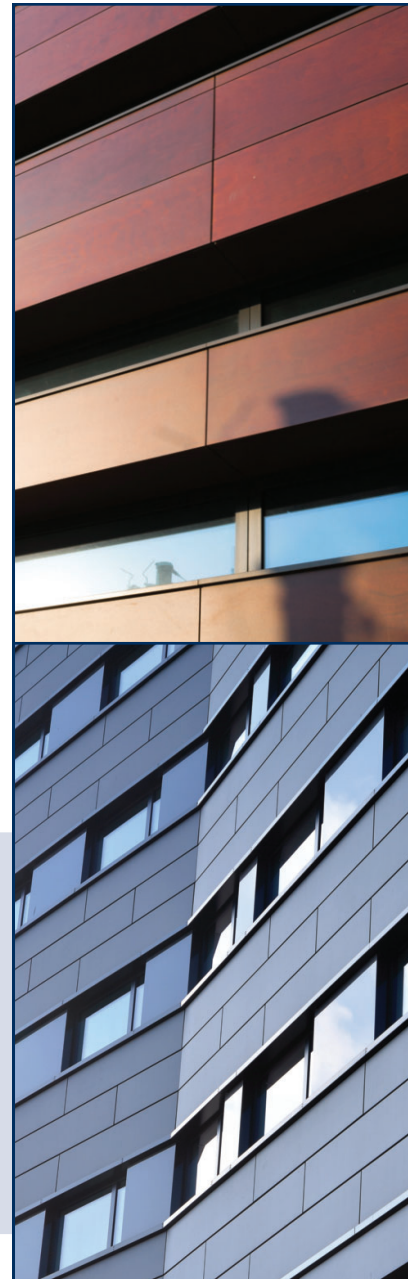

Eastern Metal Supply [www.easternmetal.com](http://www.easternmetal.com) • [info@easternmetal.com](mailto:info@easternmetal.com)

FL: 800-432-2204 • NC/DE/GA: 800-343-8154 • TX/AR/LA: 800-996-6061 • MO/OH/IN: 888-822-6061 ver 07/21

### EMS-1000 Section Detail

(Panels removed to view extrusions)

**ALUCOBOND<sup>®</sup> PLUS**

Detail views are shown as Dry Seal with no continuous insulation

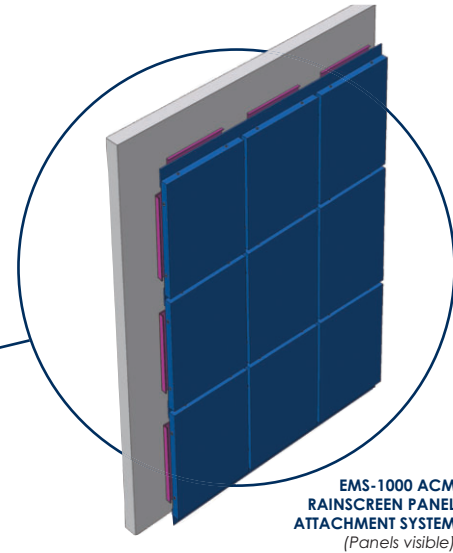
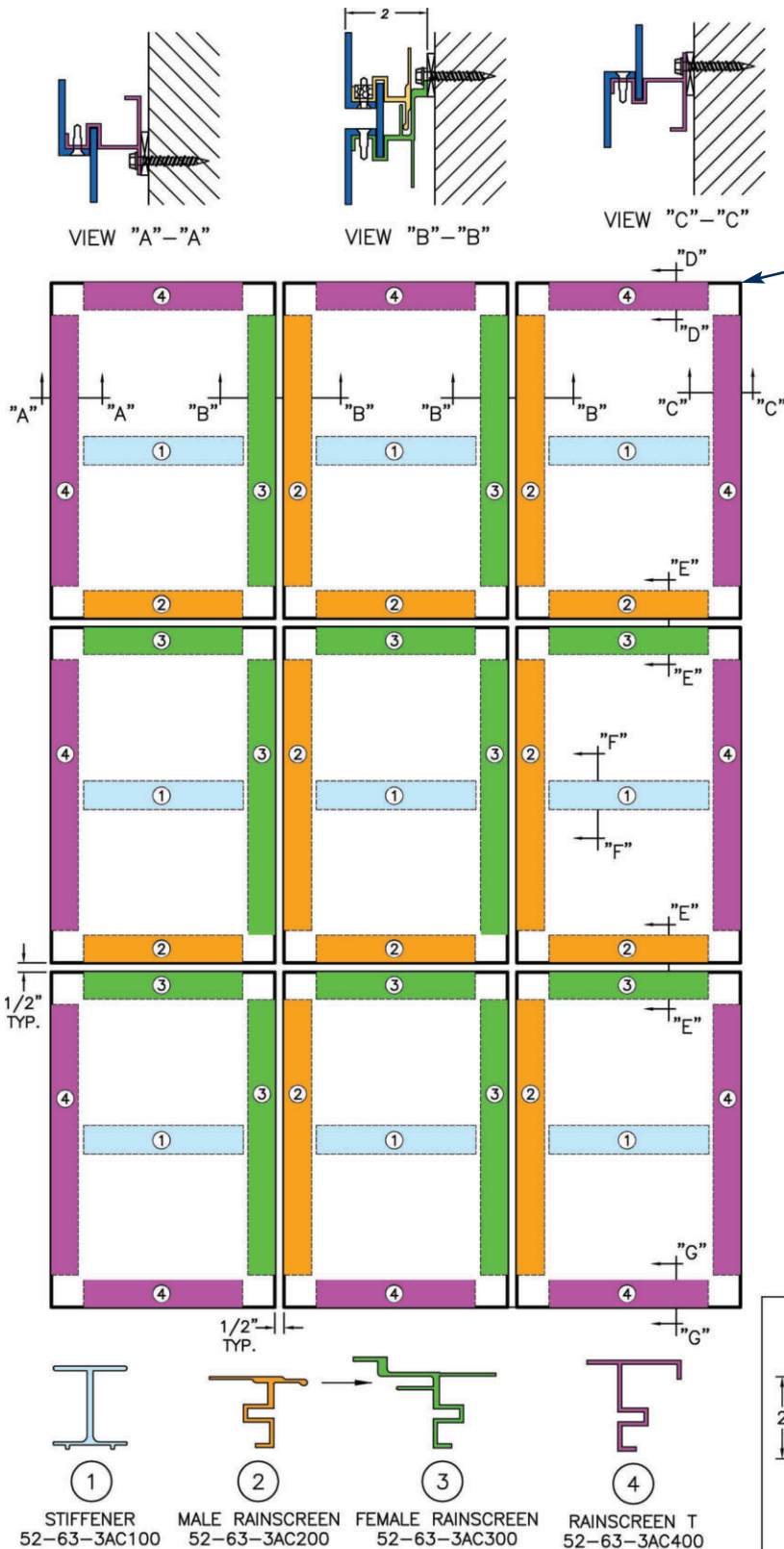

### Alternate Sealing Methods

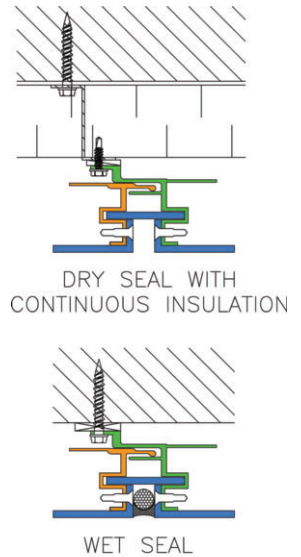

### SERVICE



EMS is bringing Panel Attachment extrusion inventory to each of our major locations.

- quick lead times
- small and large job capability
- delivery on EMS trucks
- small to no freight upcharges
- Multitude of Standard Industrial Shapes & Sheet
- Custom Extrusions
- Fast Delivery on EMS trucks
- Machining & Fabrication Capabilities



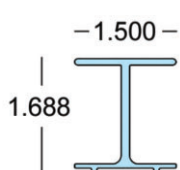
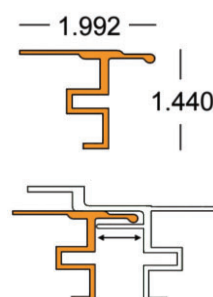
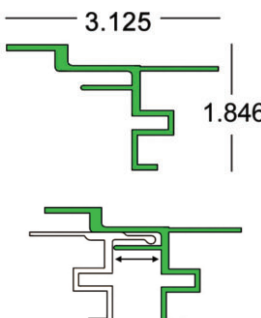
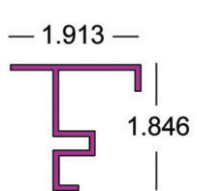
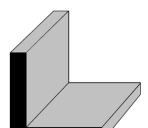

# EMS-1000 ACM Rainscreen Panel Attachment System

|  |   |  |
|--|---|--|
| <b>H-Stiffener x 16'</b><br>52-63-3AC100<br>   | <b>Male Rainscreen x 16'</b><br>52-63-3AC200<br><i>Mates with 52-63-3AC300</i><br>   | <b>Female Rainscreen x 16'</b><br>52-63-3AC300<br><i>Mates with 52-63-3AC200</i><br>                              |
| <b>Rainscreen T x 16'</b><br>52-63-3AC400<br><i>Used as wall perimeter framing</i><br> | <b>Corner Key x 0.593"</b><br>1.5" Angle x .063<br>52-63-3AC500<br>No Holes<br><b>Reinforcement</b><br>Angle x 20'<br>2" x 2" Angle x .063<br>11-63-310<br> | <p>Use Your Phone's Camera to<br/> <b>SCAN QR CODE</b><br/> for<br/> <b>Installation Instruction Guide:</b></p>  |

## CODE APPROVALS:

when mounting  
**ALUCOBOND<sup>®</sup> PLUS** PANELS  
with EMS' proprietary extrusions  
as noted.

- AAMA 509-09 DBV rainscreen
- NFPA 285 flame spread
- ASTM E330 deflection
- ASTM E72 serviceability testing

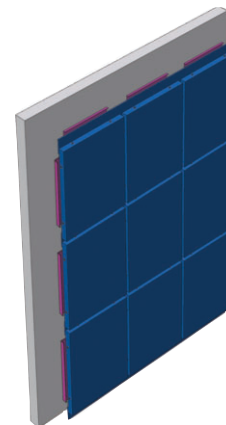

**ALUCOBOND<sup>®</sup> PLUS**

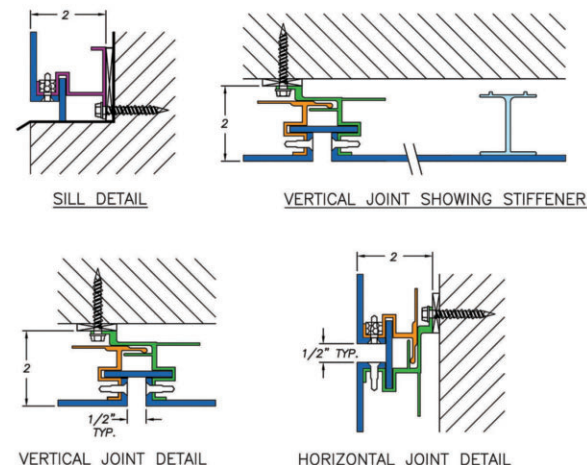

Detail views are shown as Dry Seal with no continuous insulation

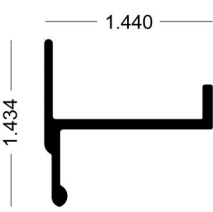
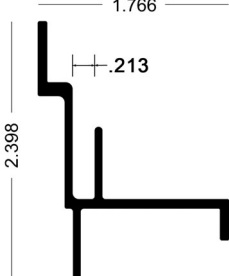
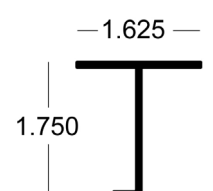
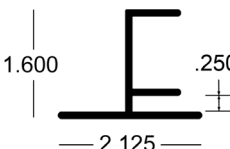
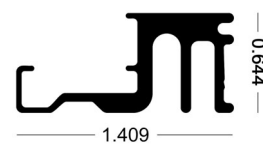
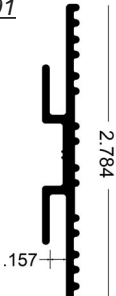
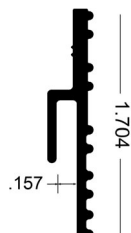
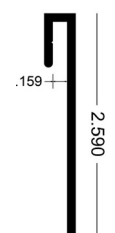
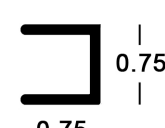

# Extruded Aluminum ACM Panel Clip System

|  |  |  |  |   |
|--|--|--|--|---|
| <b>Wet Seal Male</b><br>MILL ORDER<br><u>52-63-13113</u><br>       | <b>Wet Seal Female</b><br>MILL ORDER<br><u>52-63-12999</u><br>    | <b>Wet Seal Tee</b><br>MILL ORDER<br><u>52-63-13822</u><br>         | <b>Tie Back H-Retainer (W/D)</b><br>MILL ORDER<br><u>52-63-13520</u><br>   | <b>Perimeter Frame (W/D)</b><br>MILL ORDER<br><u>52-63-13693</u><br>   |
| <b>Double Track (W/D)</b><br>MILL ORDER<br><u>52-63-13691</u><br> | <b>Single Track (W/D)</b><br>MILL ORDER<br><u>52-63-13692</u><br> | <b>J-Clip Starter (W/D)</b><br>MILL ORDER<br><u>52-63-14109</u><br> | <b>C-Stiffener x 20' (W/D)</b><br>3/4 x 3/4 x 1/8 Channel<br>13-63-211<br> | <b>Angles x 20'</b><br>11-63-210<br>3/4 x 3/4 x 1/8<br>11-63-225<br>1 x 1 x 1/8<br>11-63-270<br>1-1/2 x 1-1/2 x 1/16<br>11-63-275<br>1-1/2 x 1-1/2 x 1/8<br> |

**ARCHITECTURAL 16**



**Eastern Metal Supply** [www.easternmetal.com](http://www.easternmetal.com) • [info@easternmetal.com](mailto:info@easternmetal.com) 09/24/22  
FL: 800-432-2204 • NC/DE/GA: 800-343-8154 • TX/LA: 800-996-6061 • MO/OH/IN: 888-822-6061